



## RETRÒ ELECTRIC



EUROPEAN WARRANTY

**MATERIAL:**

Brass elements

**FIXING KIT:**

Fixing brackets already integrated on towel rail with plugs and screws included, installation instructions.

**PACKAGING:**

The towel rail is protected by a recyclable film in polyethylene and with a box in recyclable carton.

Use and maintenance notice included.

**FINISH:**

Chrome, Antique bronze, Antique gold.

### PRODUCT CERTIFICATES



Electrical resistors: CLASS 1

Minimum class protection: IP 55

Wire Length: 1500 mm

Electrical only: Cable without electrical plug, to be connected to the power supply with a switch (not included), and protection device (not included).

Refer to the local regulations for electrical networks. Cable without plug to be connected on a ON-OFF switcher - not included

### ACCESSORIES



Pipe covering kit  
ANTIQUE GOLD

Art. Nr. 5103000000077



Pipe covering kit  
CHROME

Art. Nr. 5103000000080



Pipe covering kit  
ANTIQUE BRONZE

Art. Nr. 5103000000078

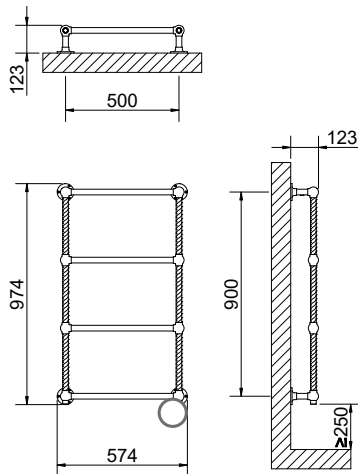

## RETRÒ I ELECTRIC

Art. Nr.	Height	Width	Finish	Watt
	H [mm]	L [mm]		
3581330000001	975	575	ANTIQUE GOLD	100
3581330000002			CHROME	
3581330000003			ANTIQUE BRONZE	

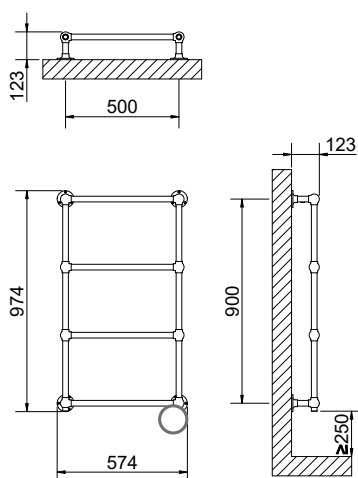

## RETRÒ II ELECTRIC

Art. Nr.	Height	Width	Finish	Watt
	H [mm]	L [mm]		
3581330000011	975	575	ANTIQUE GOLD	100
3581330000012			CHROME	
3581330000013			ANTIQUE BRONZE	

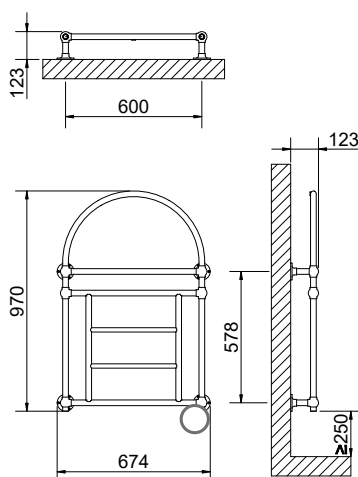

## RETRÒ III ELECTRIC

Art. Nr.	Height	Width	Finish	Watt
	H [mm]	L [mm]		
3581330000021	970	675	ANTIQUE GOLD	150
3581330000022			CHROME	
3581330000023			ANTIQUE BRONZE	

INOX STYLE

EXTRASLIM®

NEO DESIGN

CLASSIC LINE

GRAPHIC PICTURE

ACCESSORIES  
TECHNICAL SUPPORT